

Sunrise Resources plc



**A DIVERSIFIED
MINERAL
EXPLORATION &
DEVELOPMENT
COMPANY**

**Presentation to:
Mining Maven
West Midlands Investor Evening
25 February 2017**

**GOLD
DIAMONDS
INDUSTRIAL
MINERALS
SILVER**

Important Notice



The content of information contained in these slides and the accompanying verbal presentation (together, the “Presentation”) has not been approved by an authorised person within the meaning of the Financial Services and Markets Act 2000 (“FSMA”). Reliance upon this Presentation for the purpose of engaging in any investment activity may expose an individual to a significant risk of losing all of the property or other assets invested. If any person is in any doubt as to the contents of this Presentation, they should seek independent advice from a person who is authorised for the purposes of FSMA and who specialises in advising in investments of this kind.

This Presentation is being supplied to you solely for your information. This Presentation has been prepared by, and is the sole responsibility of, Sunrise Resources plc (the “Company”). The directors of the Company have taken all reasonable care to ensure that the facts stated herein are true to the best of their knowledge, information and belief.

This Presentation does not constitute, or form part of, an admission document, listing particulars or a prospectus relating to the Company, nor does it constitute, or form part of, any offer or invitation to sell or issue, or any solicitation of any offer to purchase or subscribe for, any shares in the Company nor shall it or any part of it, or the fact of its distribution, form the basis of, or be relied upon in connection with, or act as any inducement to enter into any contract therefor.

The information in this Presentation is provided as at the date of this presentation and as such is preliminary in nature, has not been fully verified by the Company and is subject to material amendment, updating and change. The Company undertake no obligation to provide the recipient with access to any additional information or to update this Presentation or any additional information or to correct any inaccuracies in any such information which may become apparent. This document sets out certain features of the Company and does not purport to provide a complete description of the Company or the shares in the Company.

No reliance may be placed for any purpose whatsoever on the information contained in this Presentation or on its completeness, accuracy or fairness thereof, nor is any responsibility accepted for any errors, misstatements in, or omission from, this Presentation or any direct or consequential loss however arising from any use of, or reliance on, this Presentation or otherwise in connection with it.

By accepting this Presentation you confirm, represent and warrant that you have consented to receive information in respect of securities of the Company and other price-affected securities (as defined in the Criminal Justice Act 1993 (“CJA”)) which makes you an “insider” for the purposes of Part V of the CJA, and you agree not to deal in any securities of the Company until such time as the inside information (as defined in the CJA) of which you have been made aware has been made public for the purposes of the CJA.

This Presentation may not be reproduced or redistributed, in whole or in part, to any other person, or published, in whole or in part, for any purpose without the prior consent of the Company. The contents of this Presentation are confidential and are subject to updating, completion, revision, further verification and amendment without notice.

The Presentation is being distributed on request only to, and is directed at, authorised persons or exempt persons within the meaning of FSMA or any order made thereunder or to those persons falling within the following articles of the Financial Services and Markets Act 2000 (Financial Promotion) Order 2005 (as amended) (the “**Financial Promotion Order**”): Investment Professionals (as defined in Article 19(5)) and High Net Worth Companies (as defined in Article 49(2)). Persons who do not fall within any of these definitions should not rely on this Presentation nor take any action upon it but should return it immediately to the Company. This Presentation is exempt from the general restriction in section 21 of FSMA relating to the communication of invitations or inducements to engage in investment activity on the grounds that it is made only to certain categories of persons.

Beaufort Securities Limited (“Beaufort”) is authorised and regulated in the United Kingdom by the Financial Conduct Authority, is acting exclusively for the Company and no-one else in connection with the proposals contained in this Presentation. Beaufort will not regard any other person as its customer or be responsible to any other person for providing the protection afforded to customers of the Company, nor for providing advice in relation to the matters detailed in this Presentation. Beaufort’s responsibilities as broker under the AIM Rules are owed solely to the London Stock Exchange plc and are not owed to the Company or to any of its directors or to any person whether in respect of such person’s decision to acquire Ordinary Shares in relation to any part of this Presentation or otherwise. Beaufort is not making any representation or warranty, express or implied, as to the accuracy, completeness or fairness in this Presentation and accepts no responsibility or liability for this Presentation and accordingly disclaims all and any liability, whether arising in tort, contract or otherwise, which it might otherwise be found to have in respect of this Presentation.

Neither this Presentation, nor any part of it, nor anything contained or referred to in it, nor the fact of its distribution, should form the basis of or be relied on in any connection with or act as an inducement in relation to a decision to purchase or subscribe for or enter into any contract or make any other commitment whatsoever in relation to any such securities. Recipients of this Presentation who decide to subscribe for the new ordinary shares in the Company are reminded that any application to so subscribe may only be made on the basis set out in the formal placing letters. In particular, details included in this Presentation are subject to updating, revision, verification and amendment and refer to events as having occurred which have not occurred at the date of this presentation but which are expected to happen in the future. This Presentation does not constitute a recommendation regarding the securities of the Company.

By receiving and/or attending this Presentation, you agree to be bound by the restrictions in this disclaimer. If you are in any doubt about the investment to which this Presentation relates, you should consult a person authorised under FSMA who specialises in advising on the acquisition of shares and other securities.

Neither this Presentation nor any copy of it should be distributed, directly or indirectly, by any means (including electronic transmission) to any persons with addresses in the United States of America (or any of its territories or possessions) (together, the “US”), Canada, Japan, Australia, the Republic of South Africa or the Republic of Ireland, or to any corporation, partnership or other entity created or organised under the laws thereof, or in any other country outside the United Kingdom where such distribution may lead to a breach of any legal or regulatory requirement. The recipients should inform themselves about and observe any such requirements or relationship.

The Company’s ordinary shares have not been, and are not expected to be, registered under the United States Securities Act 1933, as amended, (the “**US Securities Act**”) or under the securities laws of any other jurisdiction, and are not being offered or sold, directly or indirectly, within or into the US, Canada, Japan, Australia, the Republic of South Africa or the Republic of Ireland or to, or for the account or benefit of, any US persons or any national, citizen or resident of the US, Canada, Japan, Australia, the Republic of South Africa or the Republic of Ireland, unless such offer or sale would qualify for an exemption from registration under the US Securities Act and/or any other applicable securities laws.

Past Performance

This Presentation contains statements regarding the past performance of the Company’s ordinary shares. Past performance cannot be relied upon as a guide to future performance.

Forward-looking Statements

This Presentation or documents referred to in it contain forward-looking statements. These statements relate to the future prospects developments and business strategies of the Company and its subsidiaries (the “**Group**”). Forward-looking statements are identified by the use of such terms as “believe”, “could”, “envisage”, “estimate”, “potential”, “intend”, “may”, “plan”, “will” or the negative of those, variations or comparable expressions, including references to assumptions. The forward-looking statements contained in this Presentation are based on current expectations and are subject to risks and uncertainties that could cause actual results to differ materially from those expressed or implied by those statements. If one or more of these risks or uncertainties materialises, or if underlying assumptions prove incorrect, the Group’s actual results may vary materially from those expected, estimated or projected. Given these risks and uncertainties, potential investors should not place any reliance on forward-looking statements. These forward-looking statements speak only as at the date of this Presentation.

No undertaking, representation, warranty or other assurance, expressed or implied, is made or given by or on behalf of the Company or any of its directors, officers, partners, employees or advisers or any other person as to the accuracy or the completeness of the information or opinions contained herein and to the extent permitted by law no responsibility or liability is accepted by any of them for any such information or opinions. Notwithstanding the aforesaid, nothing in this paragraph shall exclude liability for any representation or warranty made fraudulently.

Directors & Officers



Patrick Cheetham
Executive Chairman

A geologist with 35 years in exploration management and 30 years as executive director of public traded companies. Currently Executive Chairman Tertiary Minerals plc.



David Swan
Non-Executive Director

Chartered Accountant. Former Group Leader in Mining and Resource Group, Ernst & Young, Sydney and CFO of Oriel Resources. Currently a director of Central Asia Metals plc.



Roger Murphy
Non-Executive Director

CEO, Sula Iron & Gold plc. Former MD Investment Banking, Dundee Securities Europe Ltd. Worked as a geologist for various companies, including Anglovaal Mining and British Petroleum.



Colin Fitch
Company Secretary

Barrister-at-Law & Chartered Secretary. Formerly Corporate Finance Director Kleinwort Benson.

Shares & Shareholders



Shares on issue	1,214,710,167
Share Price (mid. 22 February 2017)	0.14p
52 Week Low-High Range	0.11p – 0.29p
Current Market Cap.	£1.70 million
Warrants	
282,875,000 exercisable at prices from 0.135-1.25 pence	

Notified Interests		%
Tertiary Minerals plc	136,454,787	11.2
Patrick Cheetham	75,776,599	6.2
Damille Investments Limited	56,500,000	4.7
Paul Johnson	52,025,589	4.3
Charles Hall	45,500,000	3.7

SRES Share Performance



SRES: 5 year share chart at 23 February 2017 www.iii.co.uk

Directors' Interests		%
Patrick Cheetham	75,776,599	6.2
Roger Murphy	17,302,848	1.4
David Swan	8,710,863	0.7

Company Strategy & Business Plan



1

Strategic Objectives

2

To generate cash flow from more advanced projects.

Industrial minerals projects have the greatest potential to achieve an early cash flow as these typically have fewer permitting issues enabling production to advance more quickly than base or precious metal projects.

To add value through mineral discovery by drill testing necessarily more speculative exploration targets.

The highest value creation for shareholders in junior mining companies comes from early drill-discovery of precious, base metal and diamond deposits.

Company Business Plan:

- Acquire 100% of a project through research and by staking or licencing of “open ground” from the relevant authority. This allows the Company to acquire 100% ownership of valuable assets at low cost.
- To run the Company with low overheads and be a low cost explorer.
- To farm-out certain projects to reduce exploration costs.



KEY
SILVER & GOLD
PROJECTS

The Silver Market

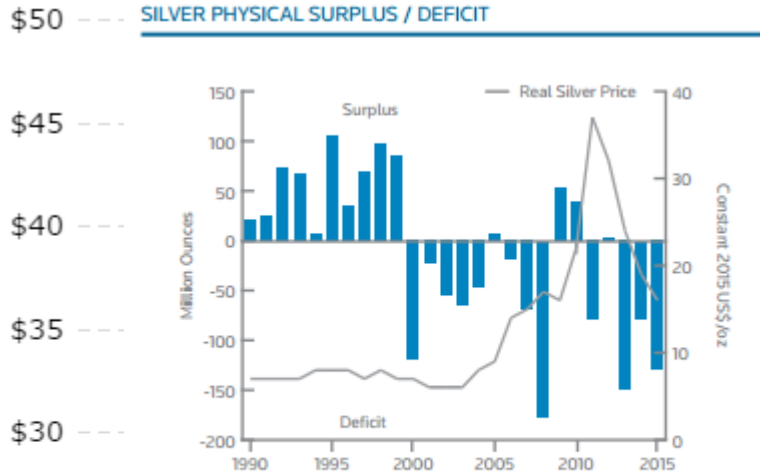

Source: GFMS, Thomson Reuters

Third consecutive year of supply deficit

2011

1979

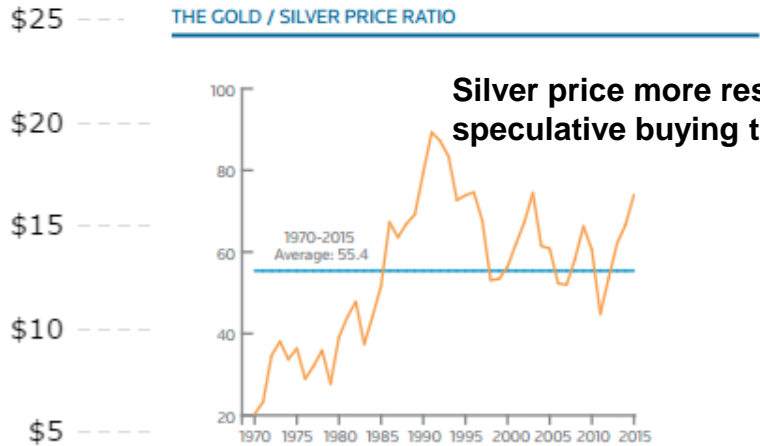

Source: Thomson Reuters Eikon

Silver price more responsive to speculative buying than the gold price

Silver Price 1917-2017

1950

2000

Bay State Silver Project - Location



Google Earth oblique view looking northwest

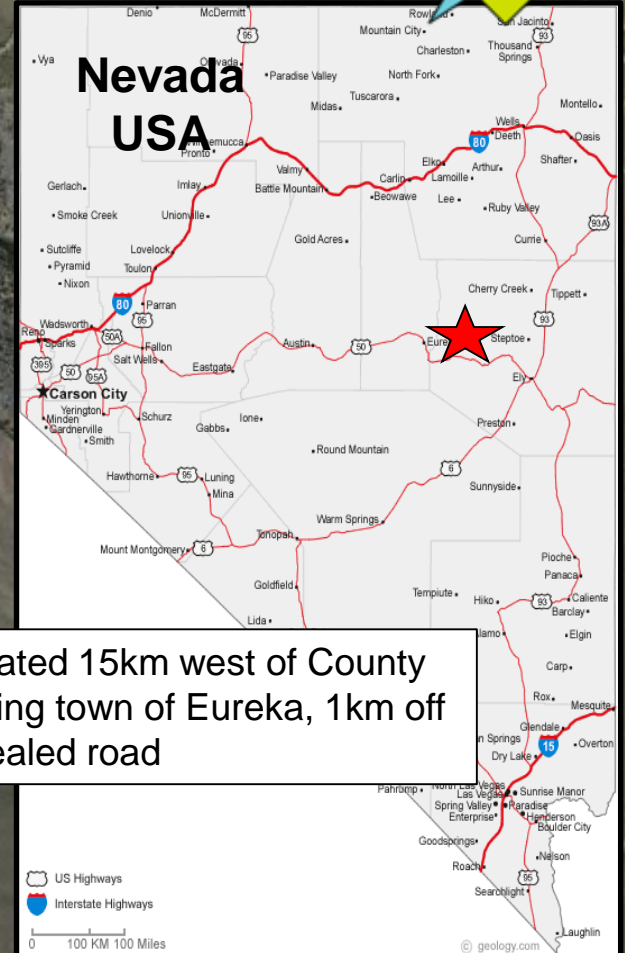
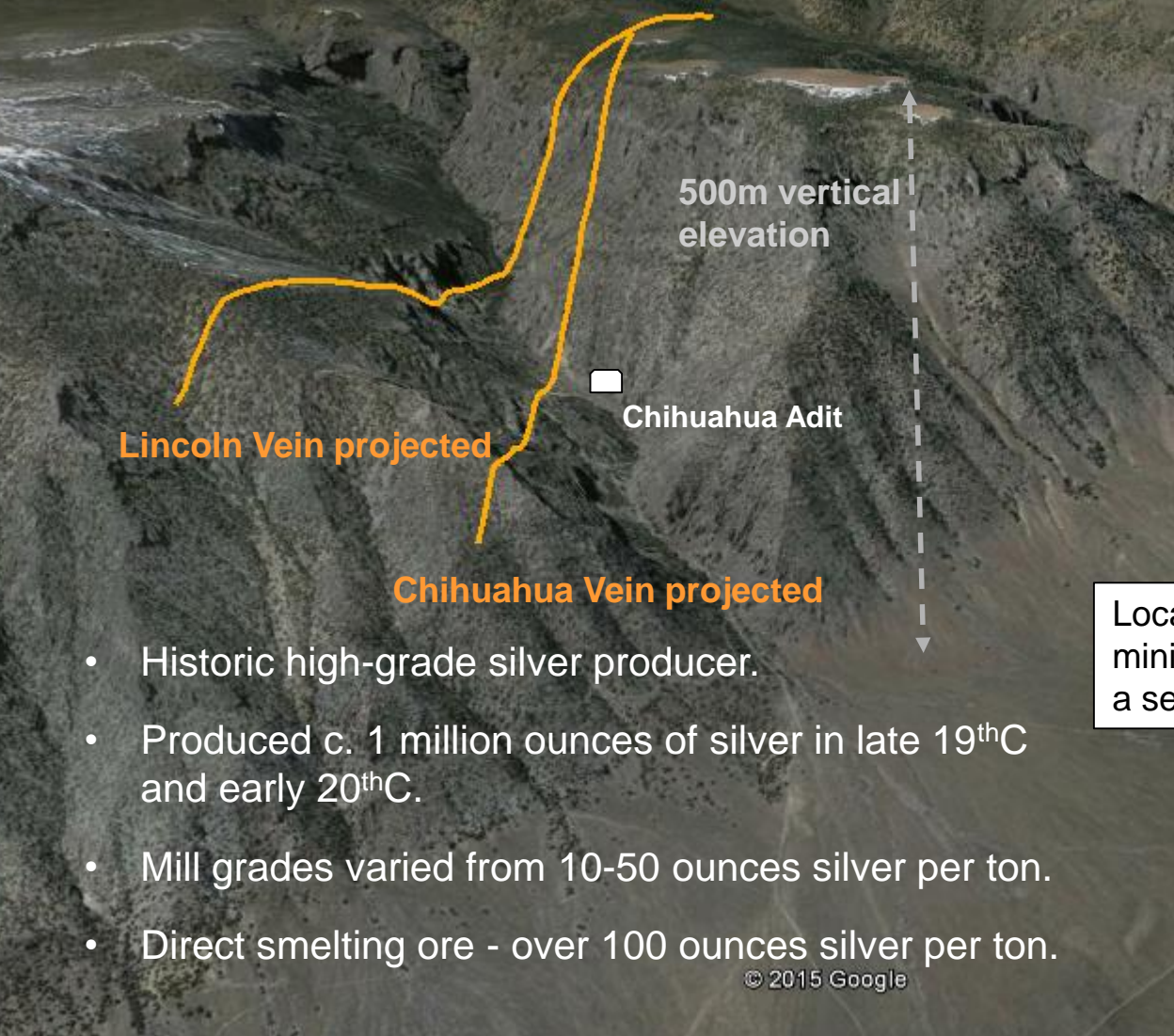

Located 15km west of County mining town of Eureka, 1km off a sealed road

- Historic high-grade silver producer.
- Produced c. 1 million ounces of silver in late 19thC and early 20thC.
- Mill grades varied from 10-50 ounces silver per ton.
- Direct smelting ore - over 100 ounces silver per ton.

© 2015 Google

Sealed road

Google

Inside the Bay State Silver Mine



Video tour of Chihuahua underground workings:

<http://www.sunriseresourcesplc.com/projects/bay-state-silver-project>



Chihuahua Vein System

- Known strike length of nearly 1km.
- Surface sampling programme:
 - average over 11 ounces/ton silver over 280m strike length.
- Underground sampling programme north along the Chihuahua adit:
 - Bonanza values up to 4kg/tonne silver (0.4% or 117oz/t) within bedded replacement style mineralisation at end of adit over 61cm (2ft).
 - Over 1kg/tonne silver (1,123g/t or 33oz/t) average for 18 samples along 230m strike length to end of adit.
 - Base metals enriched up to 10% combined lead-zinc-copper.
- The vein remains open to the north and south.

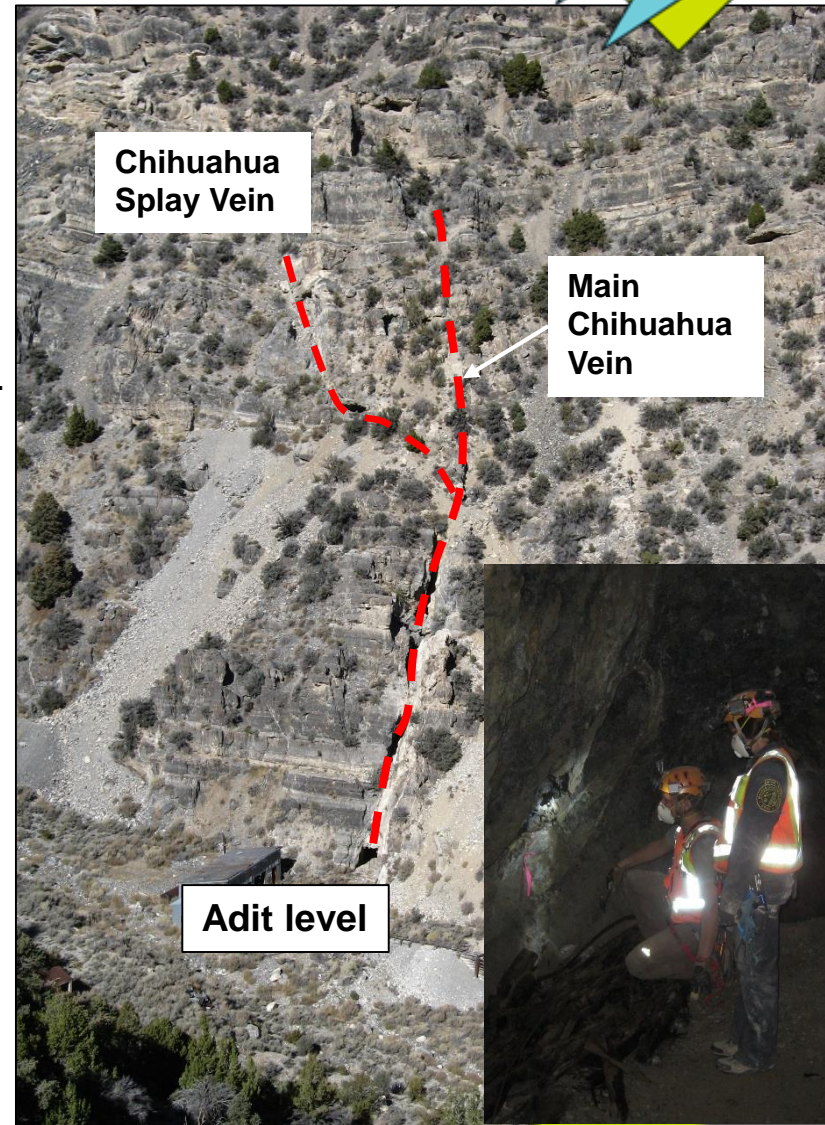

Phase 1 Drilling (2015)

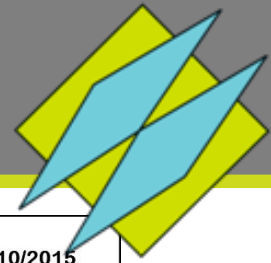

Bay State Silver Project - Schematic 3D View of Phase 1 Drilling

22/10/2015

Legend

- Drillhole completed
- Drillhole permitted, not yet drilled
- 40ft topographic contour

Oblique view looking west-northwest
View angle 45 degrees from horizontal



High grade silver intersections made in all three Phase 1 drill holes

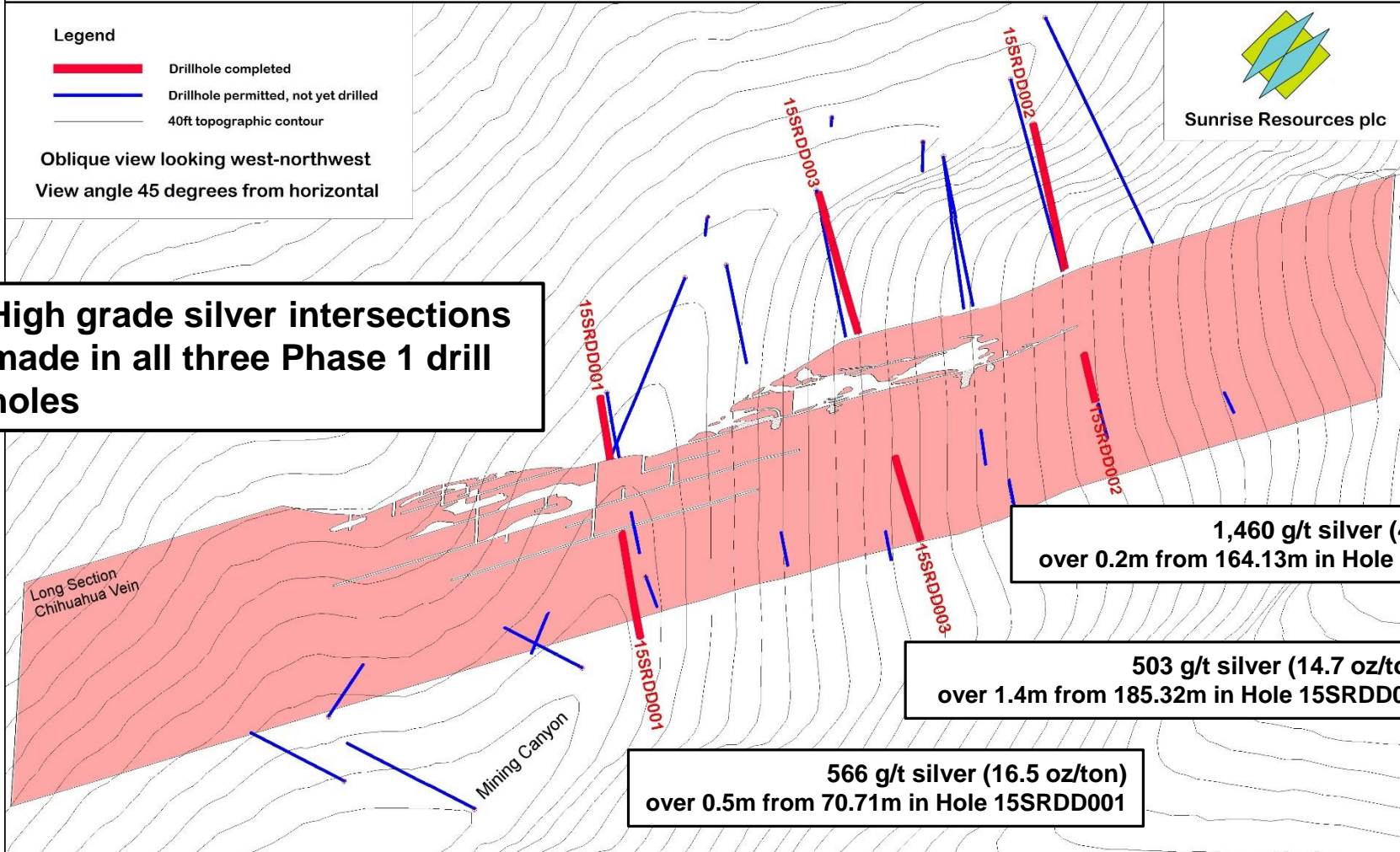

**1,460 g/t silver (42.6 oz/ton)
over 0.2m from 164.13m in Hole 15SRDD002**

**503 g/t silver (14.7 oz/ton)
over 1.4m from 185.32m in Hole 15SRDD003**

**566 g/t silver (16.5 oz/ton)
over 0.5m from 70.71m in Hole 15SRDD001**

Bay State Silver Project



Silver bearing sulphides in Hole 15SDD0003



Phase 1 & 2 Drill Plan

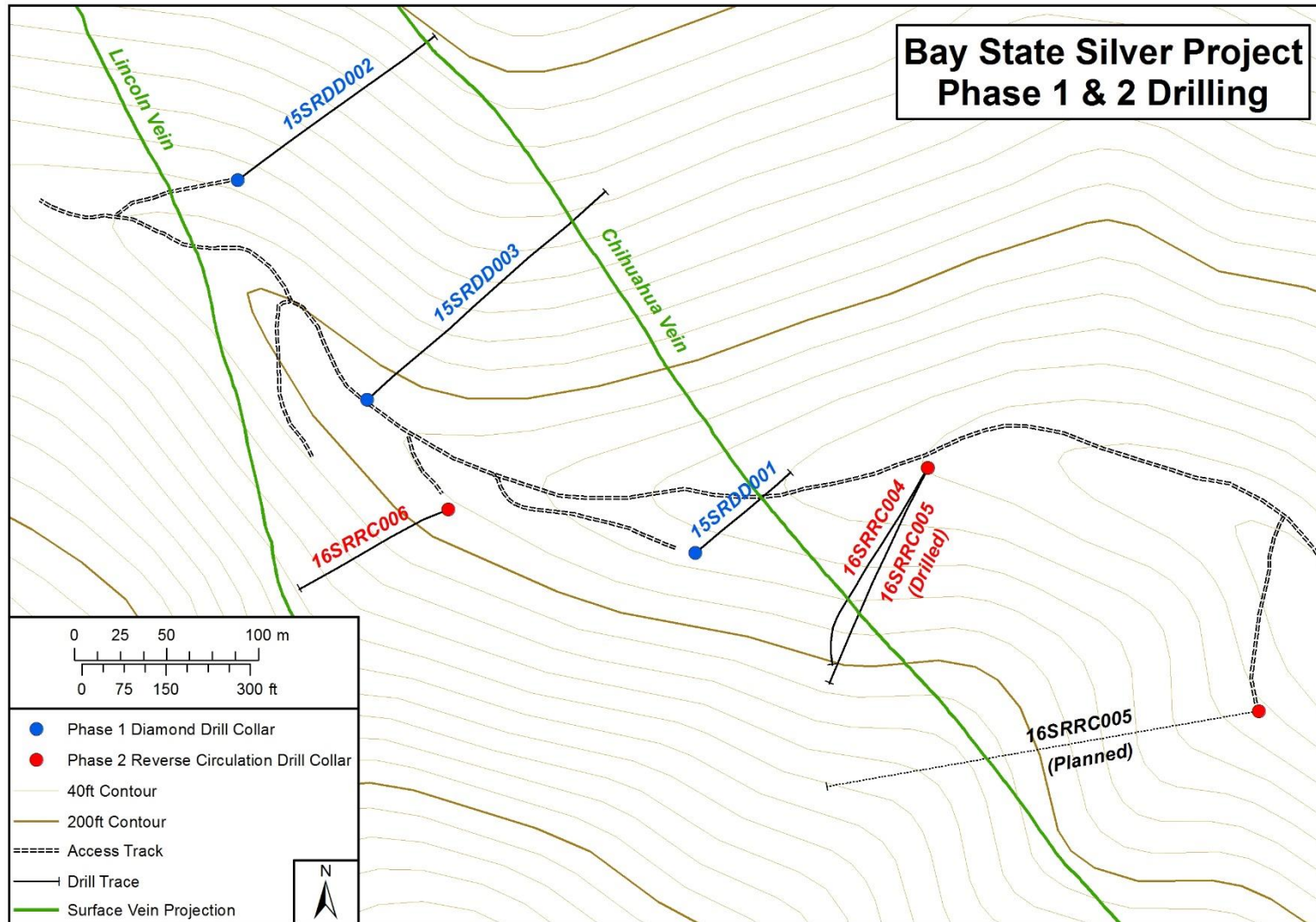

Phase 2 Drilling

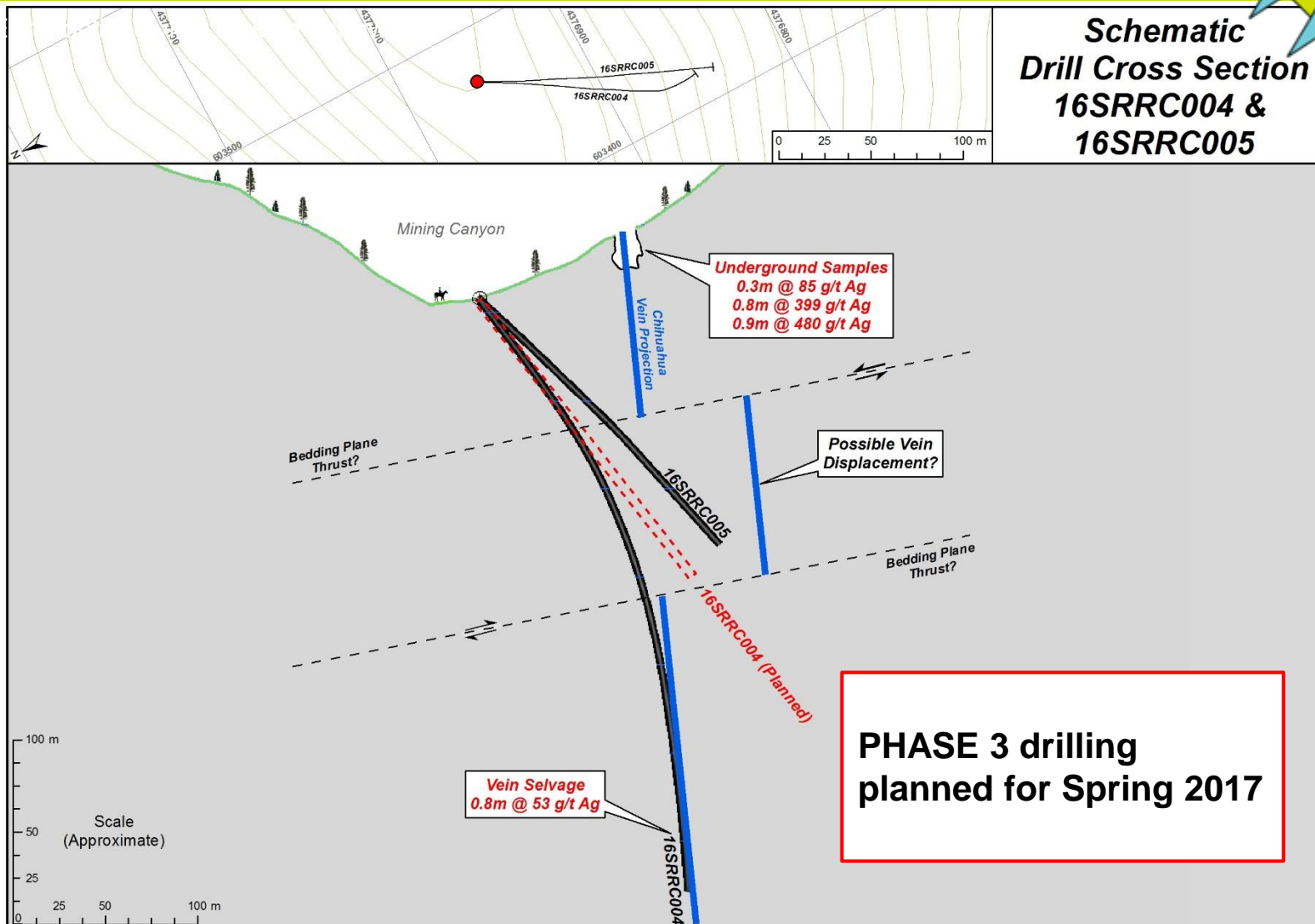
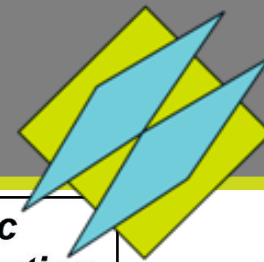

Westgold Inc., Nevada

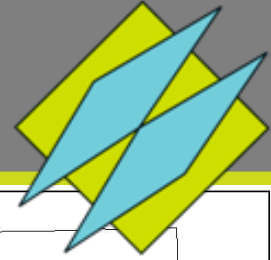

Westgold is a dedicated vehicle formed in 2016 to acquire gold & silver projects in Nevada (& western US).

Concept: to take advantage of claim relinquishments made in the mining market downturn.

- Following low cost generator model;
 - sell, lease or JV.
- Dedicated vehicle to allow deal flexibility in financing.
- Staking completed at three projects so far:

Newark (Carlin-style gold target)

Clayton (Epithermal silver-gold)

Stonewall (Epithermal silver-gold)

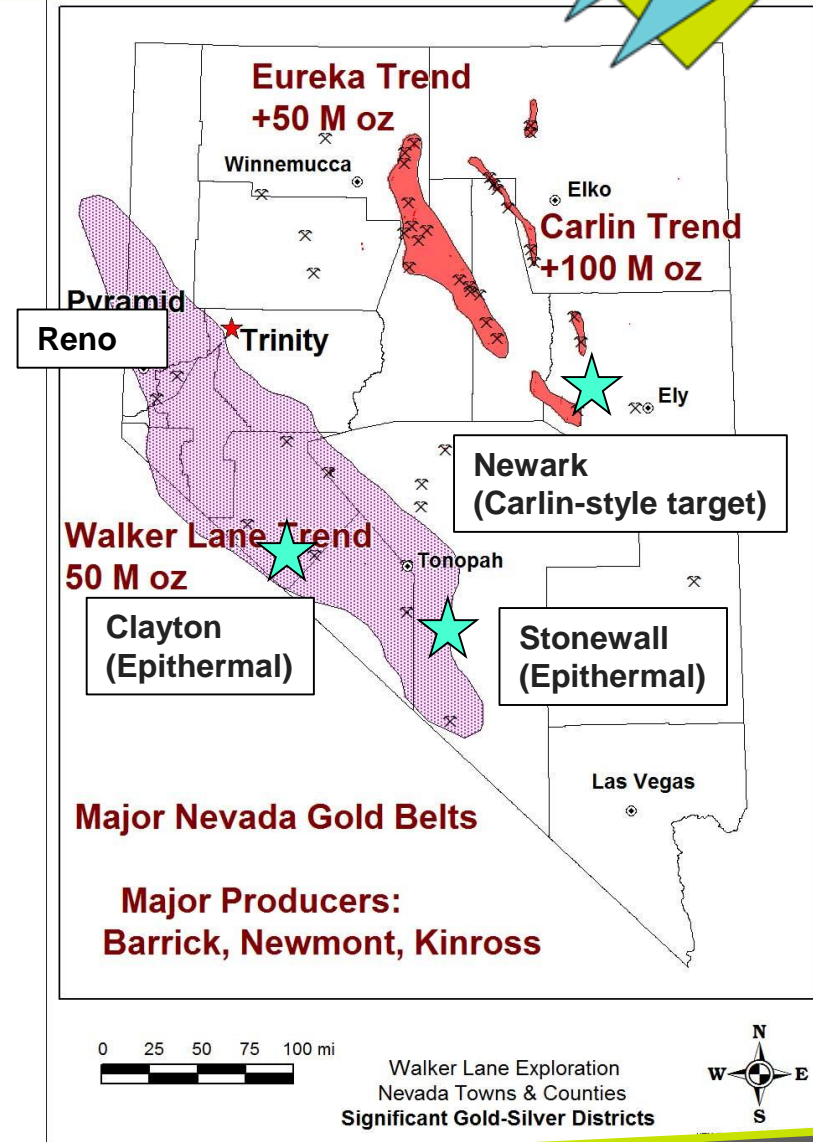

Westgold Inc., Newark Project

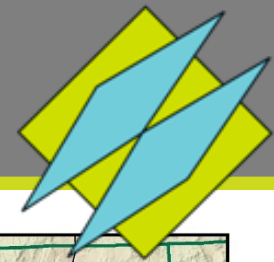

Carlin-style mineralisation:

Can be both large (e.g. Goldstrike, 39 million ounces gold @ 3.3 g/t) and high-grade (e.g. Barrick's recent Goldrush discovery, 10+ million ounces gold at a grade of 10.2 g/t).

Newark is located at south end of the Battle Mountain-Eureka Trend and Carlin-Bald Mountain-Alligator Ridge mine trends.

Newark project shows Carlin-style characteristics and analogies to nearby Alligator Ridge, Pan and Illipah Mines:

- Extensive rifting (extensional regime)
- Extensive silicification
- Thick gold-anomalous jasperoids overlying target stratigraphy in Joana Limestone and Pilot Shale
- Geochemical associations – barite, etc.

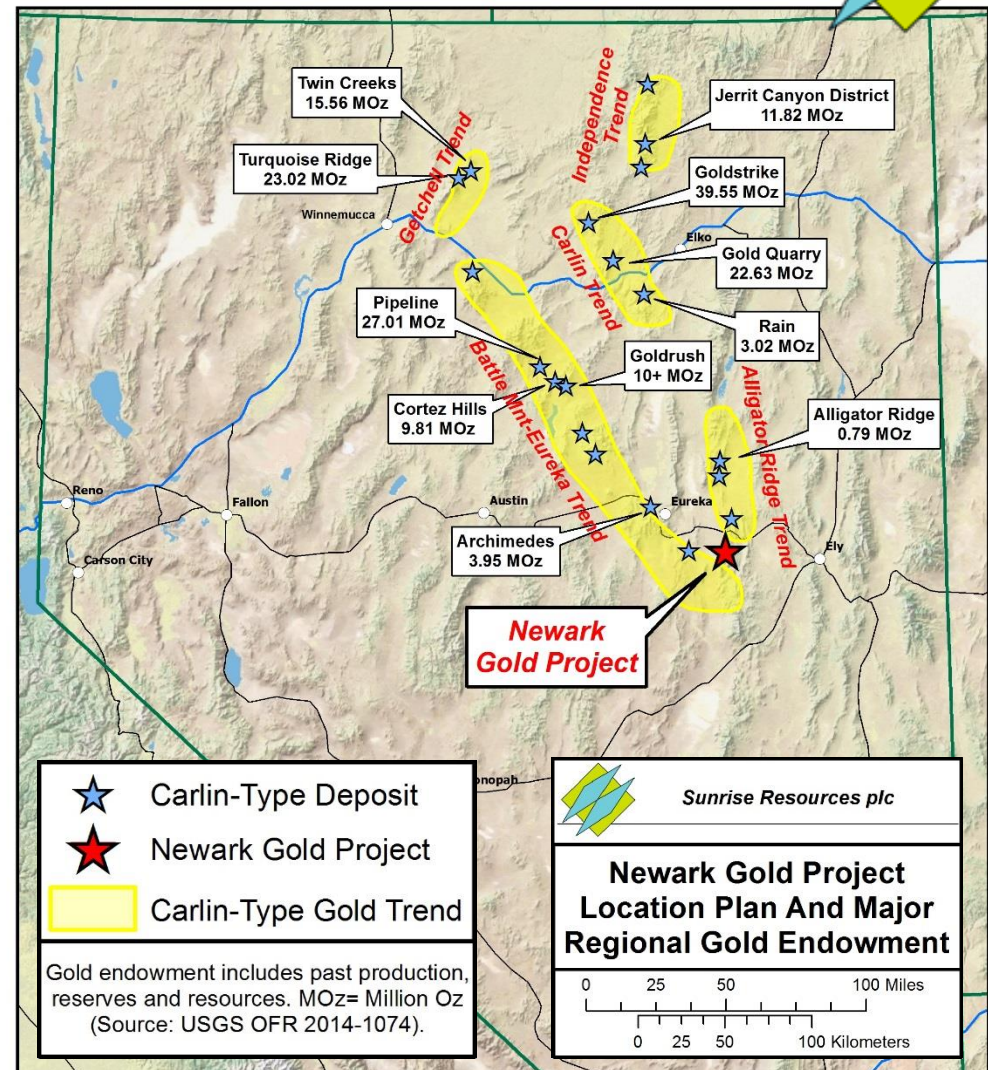

Westgold Inc., Clayton Project



- Located in Walker Lane porphyry/epithermal belt.
- Gold-silver limestone replacement target.
- Follow up historic drilling by Freeport McMoRan & Coeur.
- Wide spaced drilling results up to 7.6m grading 4.8 oz/ton silver and 0.4g/t gold at end of hole.
- Much of silver lost in the fines in drilling – grades may be understated.

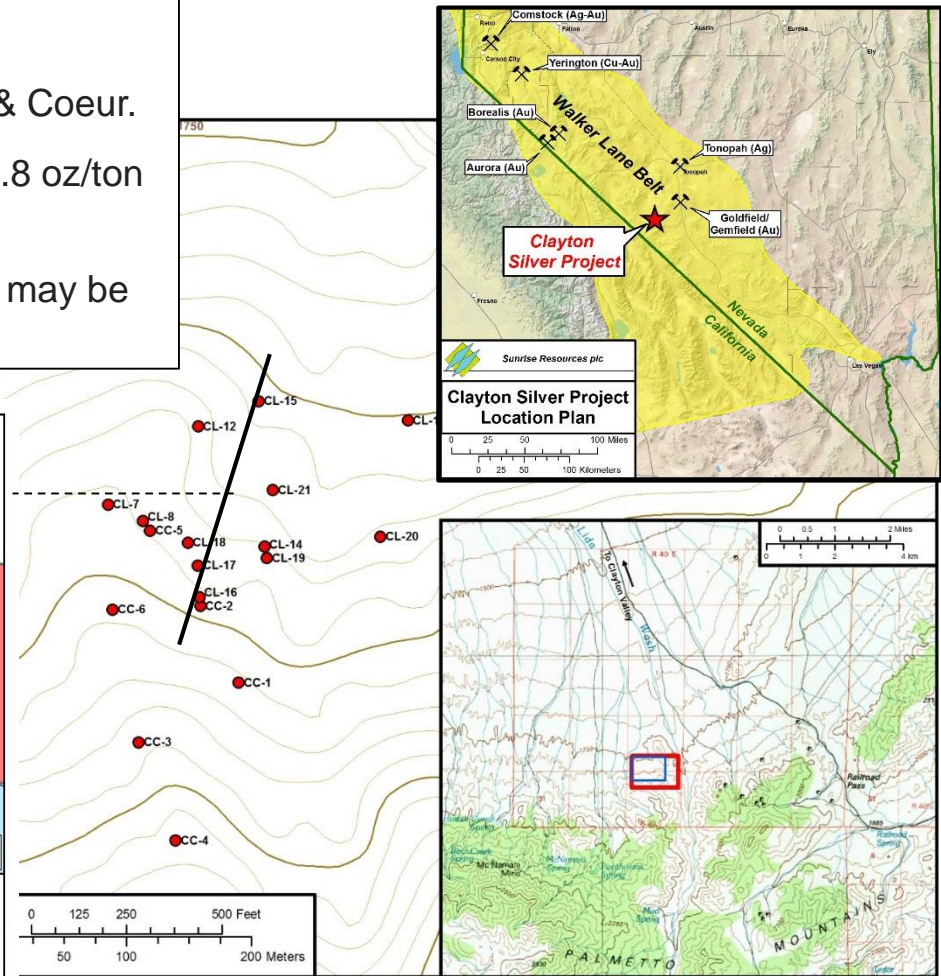
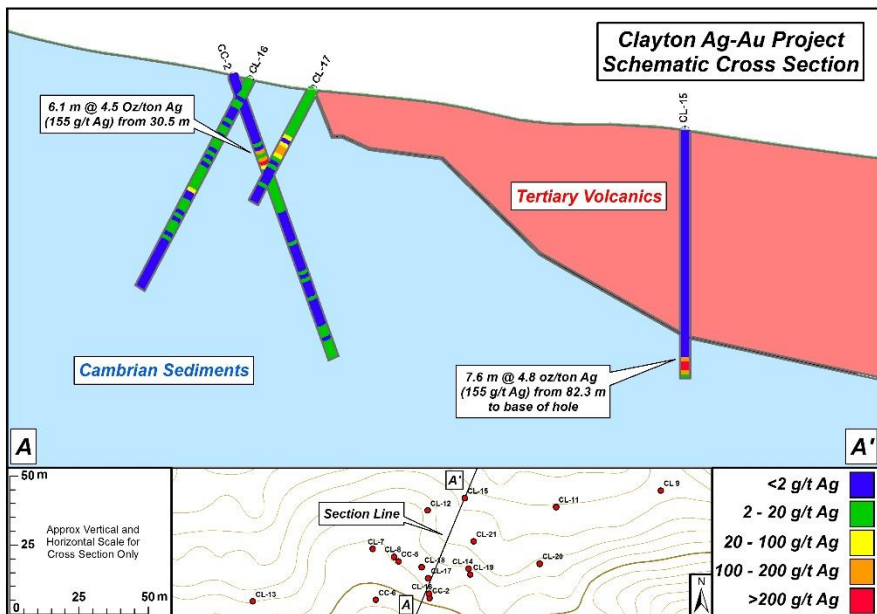

Westgold Inc., Stonewall Project



Quartz vein in range front fault

- Large epithermal vein system – up to 30m wide.
- Close to major mined epithermal deposits at Goldfield and Tonopah.
- Anomalous in gold and silver. Targeting bonanza grades in boiling zones below outcrop.



Compare : Typical epithermal colloform banding textures



Above: Midas Ken Snyder Mine, Nevada
3.7 million ounces @ grade 1.3 ounces gold/ton

Above: Stonewall Vein Textures



KEY INDUSTRIAL MINERAL PROJECTS

Sunrise Resources plc



INDUSTRIAL MINERALS are the backbone of any economy:

- affordable raw materials for infrastructure development and maintenance
- Affordable raw materials for agriculture
- High value, high performance materials for various industrial & household products

TOTAL VALUE USA:

US Non-fuel Mineral & Metal Production: \$74.6 billion

US Industrial Minerals Production: \$51.6 billion

US Industrial Minerals Production:
(excluding aggregates) \$26.5 billion

US Metal Mine Production: \$23.0 billion

US Gold Production: \$ 8.5 billion



Our Opportunity in Industrial Minerals



- Nevada is the No.1 Mining State in the USA
- Nevada is only No 19. in the value of industrial minerals production in the USA as developments mainly in metal mining
- Nevada's nearest neighbour, California, has the largest population of all the USA

Industrial Minerals should benefit from the Trump Administration's policies on infrastructure development

VALUE OF NONFUEL MINERALS PRODUCED IN 2016, BY STATE

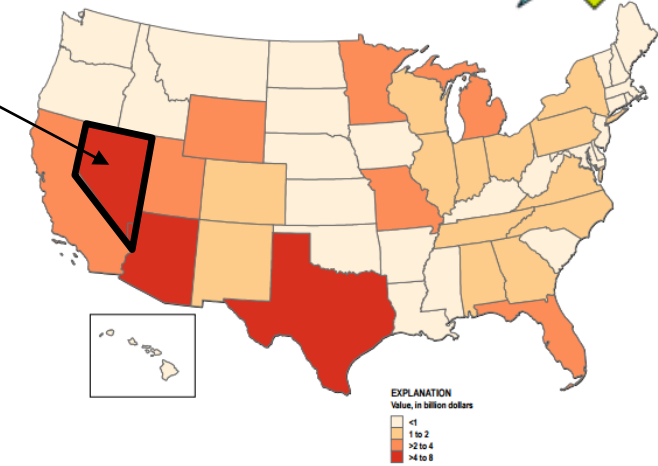

VALUE OF INDUSTRIAL MINERALS PRODUCED IN 2016, BY STATE

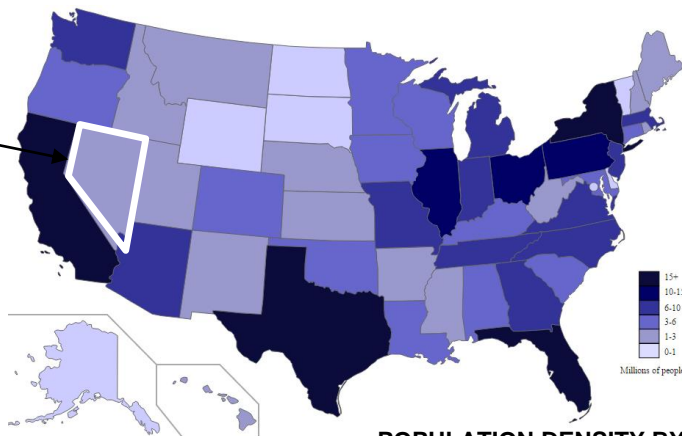
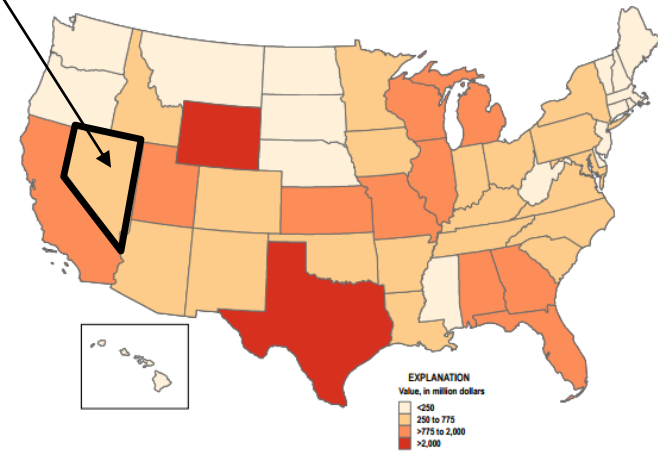

POPULATION DENSITY BY STATE

Diatomite - What is it? How is it used?

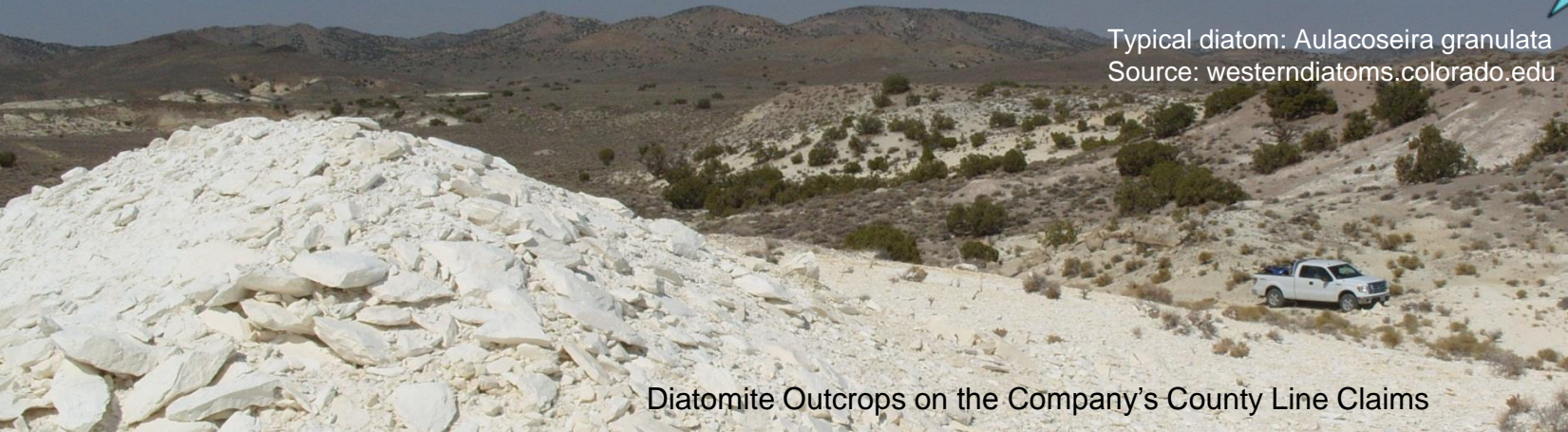
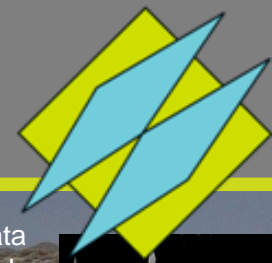

Typical diatom: *Aulacoseira granulata*
Source: westerndiatoms.colorado.edu

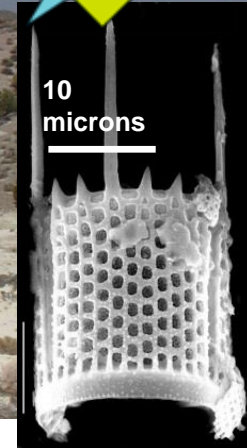

Diatomite Outcrops on the Company's County Line Claims

- Lightweight, porous, white, silica-rich rock formed by the accumulation of vast quantities of skeletal material from single-celled aquatic algae.
- It is used in **FILTRATION** of beer, liquor, wine, fats, fruit juices, biofuels and solvents due to high porosity and micro-porous texture used.
- Also used as an **INDUSTRIAL FILLER, ABSORBANT, AGRICULTURAL FEED ADDITIVE & SOIL IMPROVER** and as a lightweight **AGGREGATE** in construction.
- The value of diatomite varies widely from just US\$10s of dollars/ton for lightweight aggregate to over US\$1,000/ton for specialist products.
- Flux-calcined filter aids (58% of market): US\$640-880/ton FOB plant (source: Industrial Minerals Magazine).

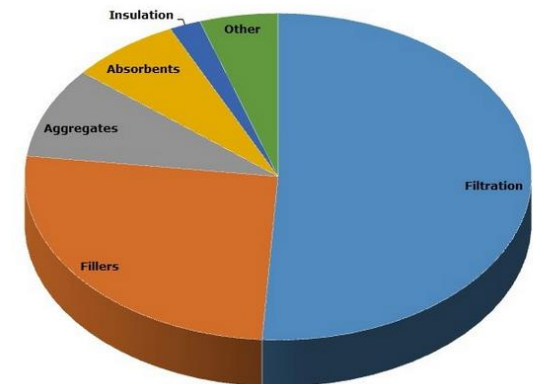

Diatomite Production, Western USA



Western USA Region is world's largest and a growing (3% growth) producer of diatomite – 925,000 tonnes in 2015.

Value of diatomite produced in western USA in 2015 was over \$300 million (ex-mine basis).

Three main producers of diatomite in western US:

- EP Minerals, LLC
- Imerys
- Grefco

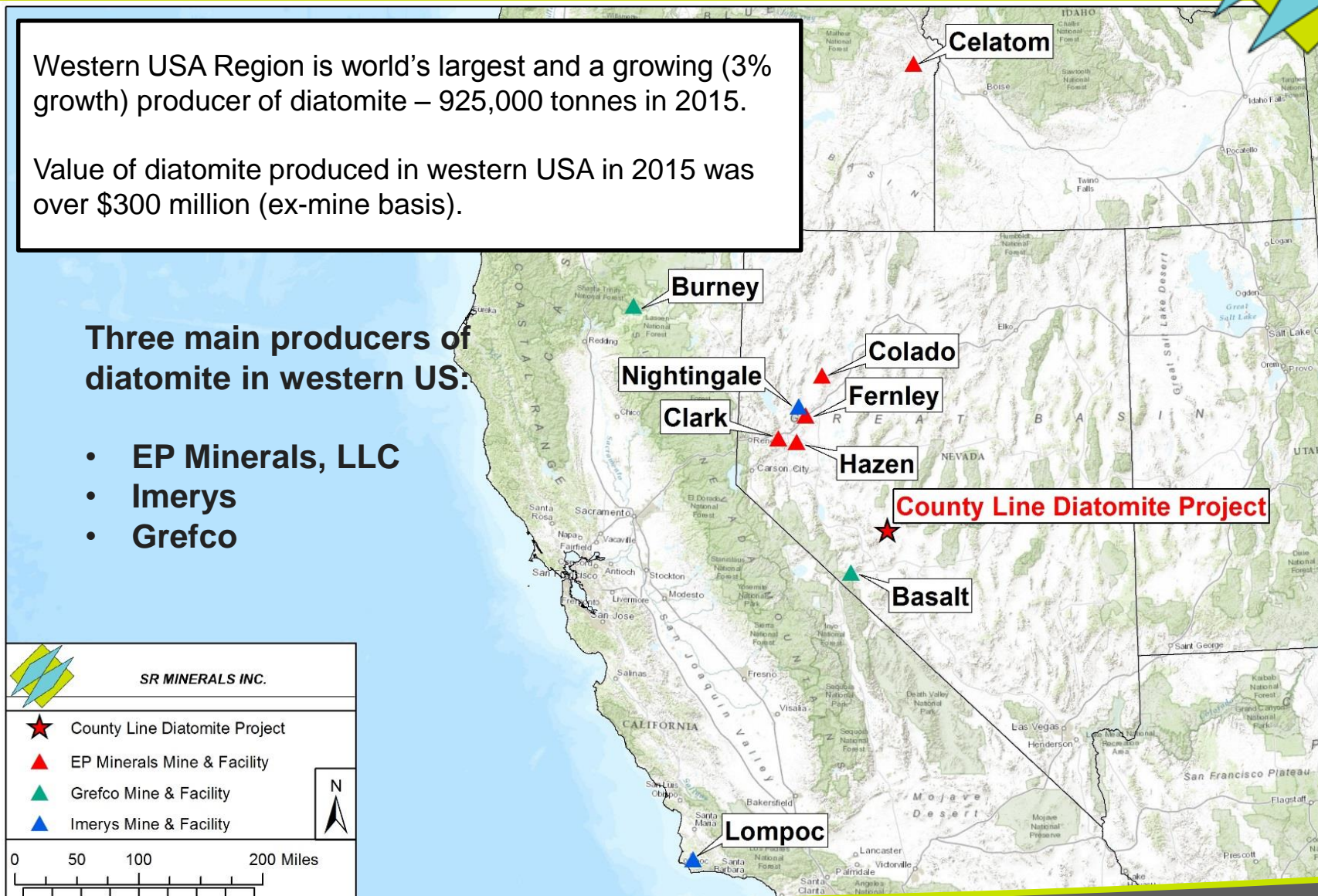

County Line Diatomite Project



- Project located 200km south east of Reno, Nevada, USA
- 109 claims covering 8sq km
- Claim area underlain by extensive beds of diatomite
- Large resource potential indicated by large aerial extent and thick vertical exposures

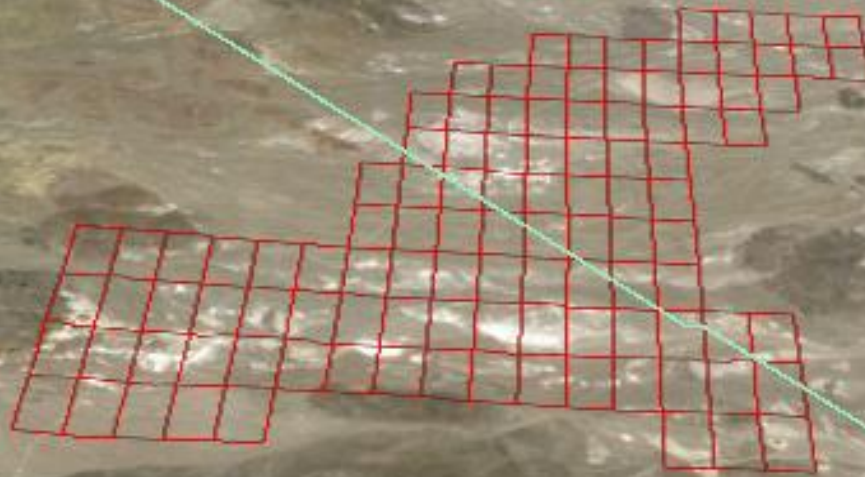

Oblique view looking North



County Line Diatomite Project



- Surface sampling programmes demonstrate consistent results over wide area.
- Testwork carried out by independent laboratories confirm samples suitable for production of higher value filter-aid products.
- Project previously leased to EP Minerals, LLC.
- Will seek Joint Venture partner to fund further evaluation and development.

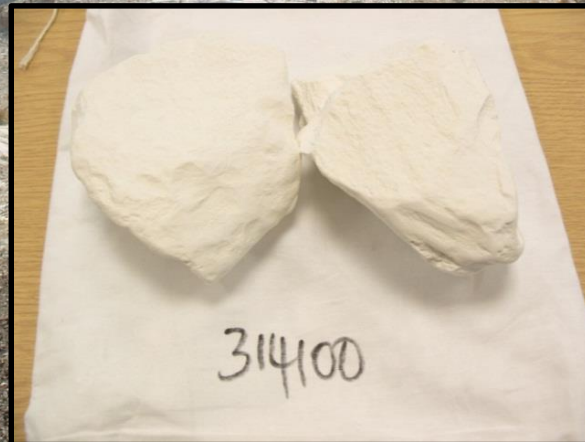

Pozzolan - What is it? How is it used?



Pozzolan is a silica or silica and aluminium rich material which will, in the presence of moisture, chemically react with lime at ordinary temperatures to form compounds possessing cement-like properties.

Pozzolans can be:

- *Industrial by-products* e.g. coal fired power station fly ash.
- *Natural* – various glassy volcanic materials such as tuff, pumice & perlite.

Pozzolan can be mixed into ordinary Portland cement in the clinker grinding stage to produce Portland pozzolan cement or substituted for Portland cement when making mortars and concrete.

The Romans were the first to use natural pozzolan on a grand scale to construct public buildings, monuments, & infrastructure such as roads and ports, many of which have endured for over 2000 years...

... in contrast, modern concretes using Portland Cement are susceptible to “concrete cancer” (alkali-silica attack).



Our Opportunity in Pozzolan



Substitution of cement with Pozzolan is being driven by greenhouse gas legislation and pressures as production of ordinary Portland Cement is responsible for 5% of the global man-made CO₂ emissions.

Coal fired power station fly ash is becoming scarcer due to phasing out of coal fired power stations and increasing emissions control.

Natural pozzolans have a growing market as a “green” alternative to Portland cement and fly ash and can improve the quality of cements and concretes by improving strength and acid sulphate resistance.

Pozzolan can typically replace 20-25% of the Portland cement used in concrete and cement mixes.

The Company’s two pozzolan projects are centrally located for the major cement plants in the Western USA and adjacent to the most populated state in the USA.

The potential for natural pozzolan is being exploited by Fortune 500 companies like BASF and innovators such as 3M.

up.

Cement Plant Locations

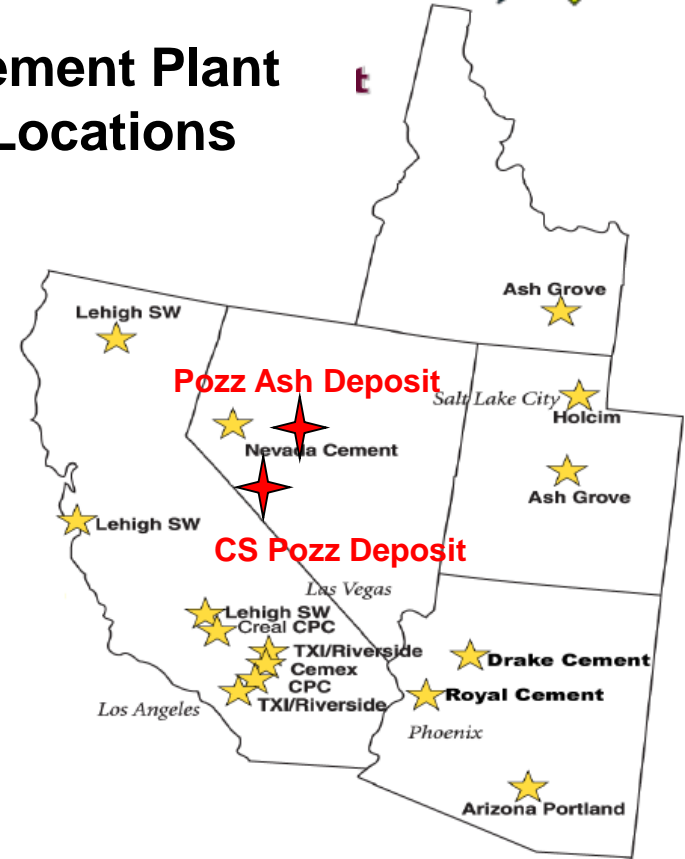

CS Pozz Deposit, Nevada



The current focus is on the CS Pozz Deposit where preliminary testing indicates that:

- the CS Deposit sample is a high quality natural pozzolan competitive with commercial deposits in the market today.
- CS Deposit sample in 20% substitution for Portland cement gave a favourably high 28 day “Strength Against Index” value of 97% (compared to 100% Portland cement) with acceptable water demand.

Typically pozzolan cement mixes exceed the strength beyond that of a 28 day cure.

Concept Study awarded to evaluate parameters for commercial production – expected completion end 1st Quarter 2017

Variability testing now in progress.



Ridge (High-Grade) Limestone Project

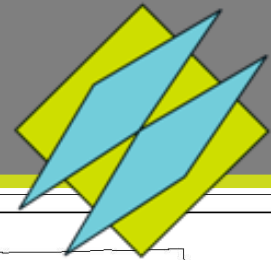

- 18 claims staked to cover large surface area of high purity limestone - 5.4 sq. km outcrop area.
- Potential for use in higher-value industrial applications.
- Favourably located adjacent to sealed highway and amenable to open-pit mining.



Ridge (High-Grade) Limestone Project



- High purity limestones may have a higher value than those used in construction aggregates.
- Used, for example, in the chemical industries, in glass manufacturing, flue gas desulphurisation and in various fillers and extenders in the rubber, sealants, plastic and paper industries.
- Also used in the manufacture of lime (calcium oxide, CaO) which is used extensively in the mining industry in Nevada.

Sample No	Calculated		XRF Analysis						
	CaCO ₃	MgCO ₃	CaO	MgO	SiO ₂	Fe ₂ O ₃	Na ₂ O	K ₂ O	Al ₂ O ₃
	%	%	%	%	%	%	%	%	%
383086	99.06	0.59	55.50	0.28	0.06	0.16	<0.01	<0.01	0.04
810008	99.06	1.26	55.50	0.60	0.29	0.03	<0.01	0.01	0.06
810009	92.99	6.90	52.10	3.30	0.33	0.07	<0.01	0.02	0.09

Next stage is mapping, sampling and testing to define tonnage potential and market applications.

The Investment Case



- Clearly defined 2-prong strategy targeting cash flow and value enhancing mineral discoveries.
- Efficient low cost explorer operating in attractive mining jurisdictions in politically stable countries.
- Exciting portfolio of drill ready “discovery-stage” silver and gold projects.
- Three key industrial minerals projects including CS Pozz Project being evaluated for early production.
- Share price near historic lows - Market Capitalisation only £1.7 million at mid-price 0.14p (23 February 2015).
- Directors fully invested - participated at significant levels in recent placings and taking fees in shares.

www.sunriseresourcesplc.com

AIM: SRES